

QUICK ATTACH™ WALL TOGGLE

316 STAINLESS STEEL



Import



Precision
Machined



Suncor
Exclusive

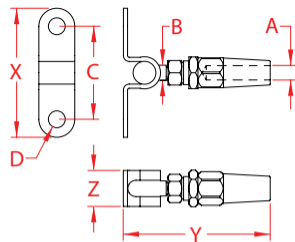
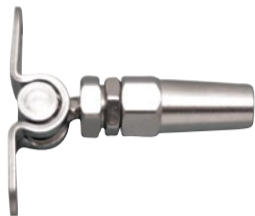

ITEM	A (wire size)	B	C	D	FASTENER	X (height)	Y (length)	Z (width)	WT (lb)	PACKAGING TYPE	EACH (qty)	INNER (qty)	CARTON (qty)	UPC
S0779-0703	1/8"	0.23"	1.58"	0.22"	#14	2.07"	2.14"	0.60"	0.11	POLYBAG	1	5	100	791506051954
S0779-0704	5/32"	0.23"	1.58"	0.22"	#14	2.16"	2.42"	0.60"	0.14	POLYBAG	1	5	100	791506051961
S0779-0905	3/16"	0.30"	2.00"	0.28"	#20	2.80"	2.85"	0.79"	0.24	POLYBAG	1	5	100	791506051978
S0779-1007	1/4"	0.35"	2.20"	0.36"	#20	3.05"	3.68"	0.87"	0.37	POLYBAG	1	1	75	791506051985

NOTE:
MECHANICAL SWAGE FITTING ALLOWS ATTACHMENT TO A FLAT SURFACE WITH ALIGNMENT THROUGH 160° +/- .
VERY FAST AND SIMPLE ATTACHMENT TO CABLE (1X19, 7X19, OR 7X7). WLL IS DETERMINED BY WLL OF WIRE USED.
ALL DIMENSIONS ARE NOMINAL (+/- 3%) AND ARE SUBJECT TO CHANGE WITHOUT NOTICE.